

NOTE:
 ALL SERVICES WITHIN THE SUBMISSION TO BE REMOVED PRIOR TO COMMENCEMENT OF CIVIL WORKS.
 ALL VEGETATION AND TREES MARKED TO BE REMOVED WITHIN THE SHOWN SQUARE TO BE REMOVED PRIOR TO COMMENCEMENT OF CIVIL WORKS BY CONTRACTOR.

REV	A	PRELIMINARY ISSUE - FOR INFORMATION USE ONLY	MS MS MM 17/09/21
			DES DWG CHK DATE

Tomkinson
 SURVEY ENGINEERING PLANNING PROJECT MANAGEMENT
 12/99-101 WESTERN AVENUE WESTWILMINGTONS WA 6155
 PH 08 9416 9988
 WWW.TOMKINSON.COM

OORANYA
 CONSULTANTS

© COPYRIGHT
 THE INFORMATION CONTAINED HEREIN IS THE PROPERTY OF TOMKINSON ENGINEERING CONSULTANTS AND IS TO BE USED ONLY FOR THE PROJECT AND SITE SPECIFICALLY IDENTIFIED IN THIS DOCUMENT. ANY REUSE OR REPRODUCTION OF THIS INFORMATION WITHOUT THE WRITTEN PERMISSION OF TOMKINSON ENGINEERING CONSULTANTS IS STRICTLY PROHIBITED.

SCALE 1:500
 LENGTHS IN METRES: PAPER SIZE A1

OORANYA ESTATE - STAGE 16A
16 WHITESIDE STREET, BEVERIDGE
EXISTING AND DRAINAGE PLAN
 AUTHORITY: WEST COAST
 PROJECT: CIVIL CONSTRUCTION DEVELOPMENTS PH
 ONE STAGE
PRELIMINARY S1488_16A-R&D02A

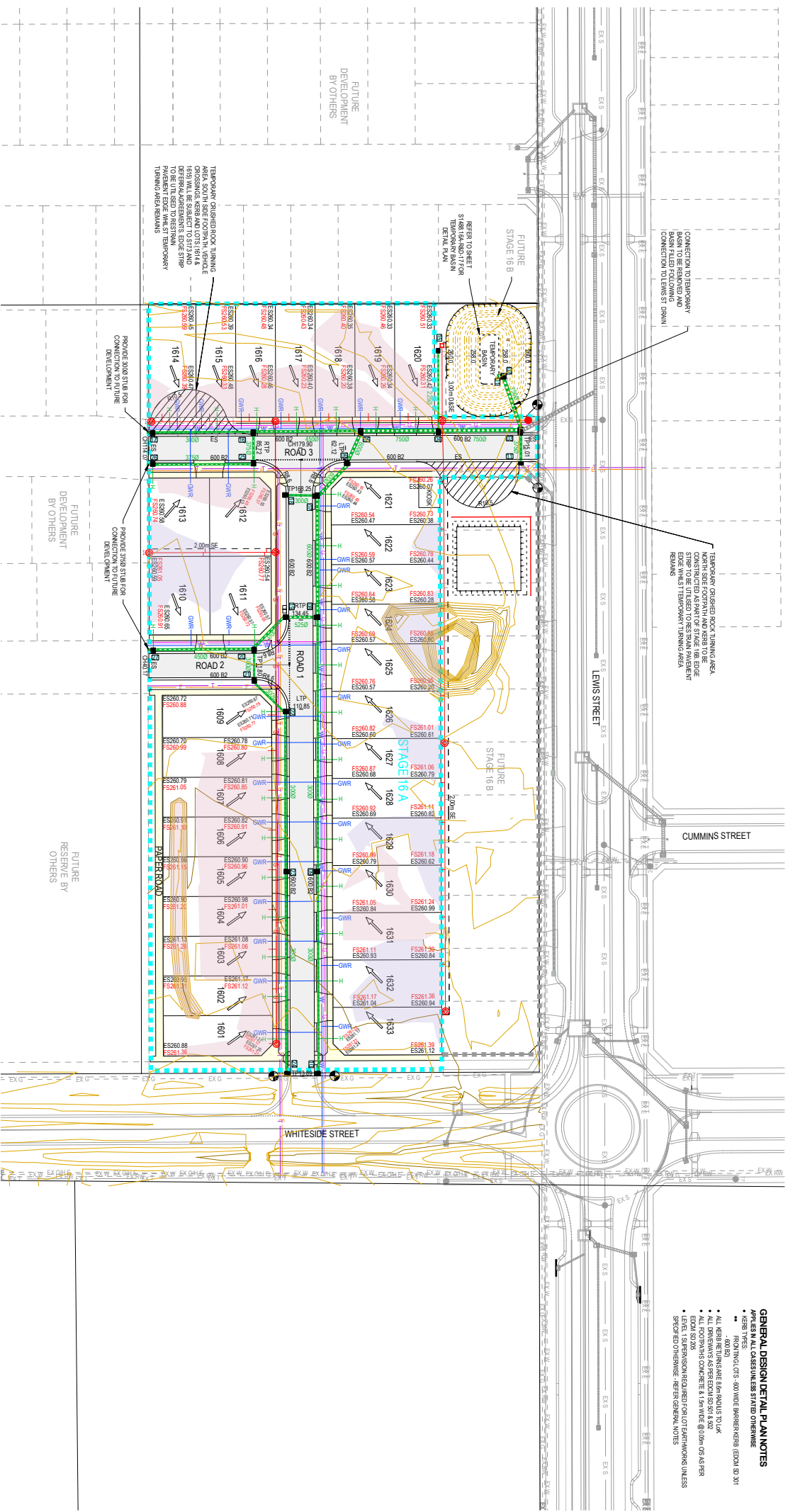

- GENERAL DESIGN DETAIL PLAN NOTES**
- APPLIES IN ALL CASES UNLESS STATED OTHERWISE
 - KERB TYPES
 - FROM IN/OUTS: 600MM BANNERKERB (ECON 83 301)
 - ALL KERB SETTING SHALL BE 600MM TO LOK
 - ALL DRIVEWAYS AS PER DDM 501 & 502
 - ALL ROYALTY CONCRETES & 150MM @ 100MM OS AS PER LEVEL 1 SUPERVISION REQUIRED ON LOT FORTHWARDS UNLESS SPEC'D OTHERWISE - REFER GENERAL NOTES

A PRELIMINARY ISSUE - FOR INFORMATION USE ONLY
 REVISION _____
 MS MS MM 17/09/21
 DES DWG CHK DATE

 12/99-101 WESTERN AVENUE WESTWILMINGTONS WA 6155
 ASB T 08 9383 538 WWW.TOMKINSON.COM



© COPYRIGHT
 THE INFORMATION CONTAINED HEREIN IS THE PROPERTY OF TOMKINSON & ASSOCIATES PTY LTD. ALL RIGHTS RESERVED. NO PART OF THIS DOCUMENT IS TO BE REPRODUCED OR TRANSMITTED IN ANY FORM OR BY ANY MEANS, ELECTRONIC OR MECHANICAL, INCLUDING PHOTOCOPYING, RECORDING, OR BY ANY INFORMATION STORAGE AND RETRIEVAL SYSTEM, WITHOUT THE WRITTEN PERMISSION OF TOMKINSON & ASSOCIATES PTY LTD.

SCALE 1:500
 LENGTHS IN METRES - 7-PAPER SIZE A1

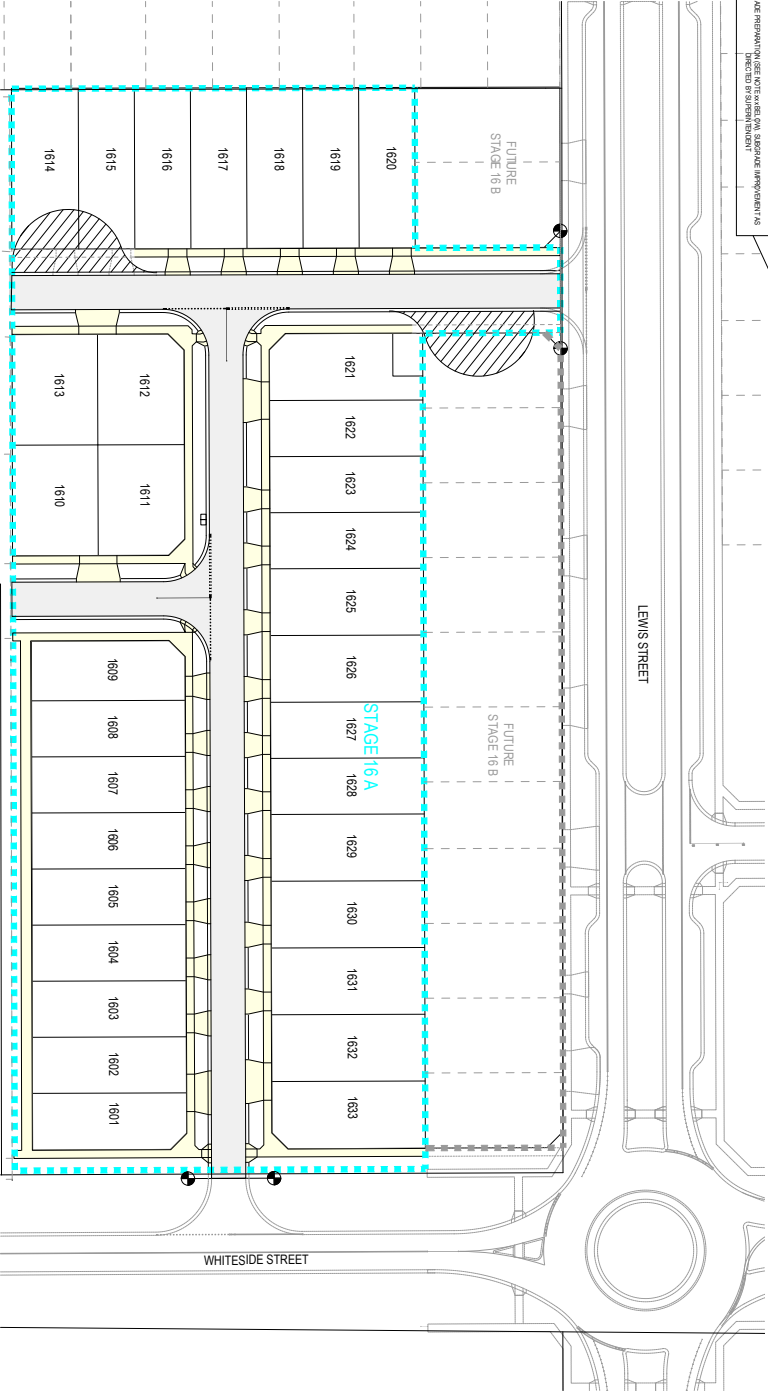
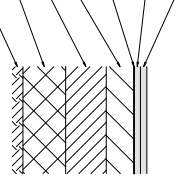

OORANYA ESTATE - STAGE 16A
16 WHITESIDE STREET, BEVERIDGE
ROAD AND DRAINAGE PLAN
 DETAIL PLAN
 AUTHORITY: MITCHELL COUNCIL
 PROJECT STATUS: CONDUITS ONLY DEVELOPMENTS PH
 PROJECT NUMBER: S1458.16A-R&D03 A
 REV: _____

480mm DEPTH ACCESS STREET PAVEMENT	LAYER THICKNESS (mm)	MATERIAL
1 FINISH COURSE	30	SIZE 7 FINE HASHPALT
2 BASE COURSE	30	SIZE 4 FINE HASHPALT
3 SUBGRADE IMPROVEMENT		50MM NOM. SIZE CLASS 2 FINE CHANGED ROCK (SEE NOTE 3 BELOW) 20MM NOM. SIZE CLASS 2 FINE CHANGED ROCK (SEE NOTE 3 BELOW) 20MM NOM. SIZE CLASS 2 FINE CHANGED ROCK (SEE NOTE 3 BELOW)
4 BASE COURSE	50	20MM NOM. SIZE CLASS 2 FINE CHANGED ROCK (SEE NOTE 3 BELOW)
5 SUBGRADE COURSE	50	20MM NOM. SIZE CLASS 2 FINE CHANGED ROCK (SEE NOTE 3 BELOW)
6 CAPPING LAYER	50	20MM NOM. SIZE CLASS 2 FINE CHANGED ROCK (SEE NOTE 3 BELOW)
7 SUBGRADE		SUBGRADE PREPARATION SET TO 50MM NOM. SUBGRADE IMPROVEMENT AS PER STANDARD DRAWING EDDM 202 FOR EXPANSIVE SUBGRADES



STD SINGLE & DOUBLE CONCRETE DRIVEWAY PAVEMENT DETAILS (EDM 901-902) OR CONCRETE FOOTPATH PAVEMENT DETAILS (EDM 801)	LAYER THICKNESS (mm)	MATERIAL
1 SURFACE FINISH		BROOKFIELD TYPED FINISH, FINISHED SURFACE TO CONFORM AS PER STANDARD DRAWING EDDM 901-902 OR CONCRETE FOOTPATH PAVEMENT DETAILS (EDM 801)
2 COURSE	50	CONCRETE 20MM WITH 1.5% STONE FINE FIBRE WITH 10MM MIN. COARSE AGGREGATE
3 JOINT	90	20MM NOM. SIZE CLASS 2 FINE CHANGED ROCK (SEE NOTE 3 BELOW)
4 SUBGRADE		SUBGRADE PREPARATION SET TO 50MM NOM. SUBGRADE IMPROVEMENT AS PER STANDARD DRAWING EDDM 202 FOR EXPANSIVE SUBGRADES



250mm DEPTH PAVEMENT COMPOSITION B	LAYER THICKNESS (mm)	MATERIAL
PAVEMENT LAYER		
1 BASE COURSE	250	20MM NOM. SIZE CLASS 2 FINE CHANGED ROCK (SEE NOTE 3 BELOW)
2 EXISTING PAVEMENT (CARPARKING)		SUBGRADE PREPARATION SET TO 50MM NOM. SUBGRADE IMPROVEMENT AS DIRECTED BY SUPERINTENDENT

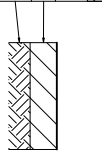

- PAVEMENT NOTES:**
- PAVEMENT SHALL BE INSTALLED IN ACCORDANCE WITH BEST PRACTICE DRAINAGE AND BEEN APPROVED FROM APPROVED CONSTRUCTION PLANS BY SMC FOR CONNECTING ADJACENT STAGES FROM W/LABOURAL ESTIMATE
 - PAVEMENT BASE COURSE ARE TO BE COMPACTED TO A MINIMUM DRY DENSITY 90% OF 99% MOISTURE MODIFIED WITH MOISTURE CONTENT WITH 1.5% OF MOISTURE OPTIMUM MOISTURE CONTENT (MOMC)
 - PAVEMENT SUBGRADE COURSE ARE TO BE COMPACTED TO A MINIMUM DRY DENSITY 90% OF 98% MOISTURE MODIFIED WITH MOISTURE CONTENT WITH 1.5% OF MOISTURE OPTIMUM MOISTURE CONTENT (MOMC)
 - MOISTURE CONTENT WITH 1.5% OF STANDARD OPTIMUM MOISTURE CONTENT (SOMC) STANDARD WITH
 - PAVEMENT LAYERS SHOULD BE PLACED AND COMPACTED IN LAYERS NOT EXCEEDING 200mm THICKNESS
 - SUBGRADE PREPARATION AND ENGINEERED FILL CONSTRUCTION PAVEMENTS TO BE IN ACCORDANCE WITH STANDARD DRAWING EDDM 202 FOR EXPANSIVE SUBGRADES
 - THE SUBGRADE MUST THEN BE REGULATED WITH COUNCIL APPROVED MATERIAL
 - WHEN PAVEMENT EXCAVATION IS IN ROCK, ALL LOOSE MATERIAL (MUD, ROCK & CLAY) MUST BE REMOVED
 - PAVEMENT EXCAVATION IS IN ROCK, ALL LOOSE MATERIAL (MUD, ROCK & CLAY) MUST BE REMOVED
 - BE USED MUST BE OBTAINED FROM COUNCIL
 - ALL SUBGRADE PREPAREMENTS TO BE CONSTRUCTED AS PER STANDARD DRAWING EDDM 202 FOR EXPANSIVE SUBGRADES

MS MS 161 17/09/21
DES DWG CHK DATE

1299-101 WESTERN AVENUE WESTWOODS PH 03 8746 9888
ASB T 103 585 558 WWW.TOMKINSON.COM

Tomkinson
SURVEY ENGINEERING PLANNING PROJECT MANAGEMENT

COORANYA
CONSTRUCTION MANAGEMENT

SCALE 1:500
LENGTHS IN METRES - PAPER SIZE A1

© COPYRIGHT
THIS DRAWING IS THE PROPERTY OF
COORANYA CONSTRUCTION MANAGEMENT
AND SHALL REMAIN THE PROPERTY OF
COORANYA CONSTRUCTION MANAGEMENT
IF REPRODUCED WITHOUT THE WRITTEN
CONSENT OF COORANYA

16 WHITESIDE STREET, BEVERIDGE
ROAD AND DRAINAGE PLAN
PAVEMENT PLAN & DETAILS
PROJECT NUMBER
S1458.16A-R&D05 A

PRELIMINARY

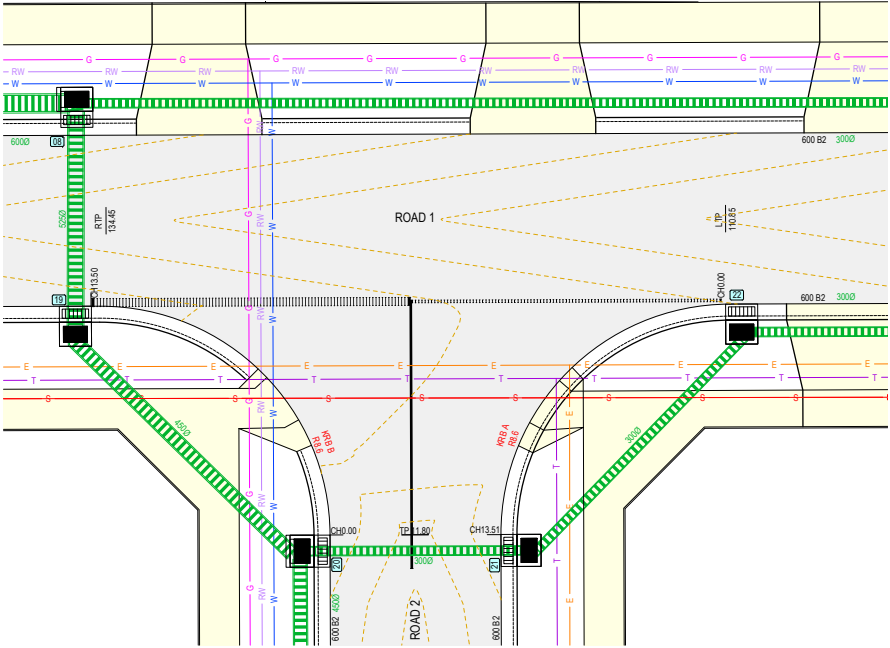

KRB-A
SCALE H: 1:500 V: 1:50

DESIGN L.P. OF KERB	HORIZ. GEOMETRY	DATE/NO. 20/0	EXISTING SURFACE	CHANGE
0.00	0.00	260.50	260.50	0.00
2.00	0.00	260.66	260.49	0.17
4.00	0.00	260.65	260.49	0.16
6.00	0.00	260.59	260.48	0.11
8.00	0.00	260.65	260.48	0.17
10.00	0.00	260.65	260.47	0.18
12.00	0.00	260.63	260.47	0.16
13.51	0.00	260.63	260.46	0.17

KRB-B
SCALE H: 1:500 V: 1:50

DESIGN L.P. OF KERB	HORIZ. GEOMETRY	DATE/NO. 20/0	EXISTING SURFACE	CHANGE
0.00	0.00	260.46	260.46	0.00
2.00	0.00	260.58	260.45	0.13
4.00	0.00	260.58	260.44	0.14
6.00	0.00	260.58	260.43	0.15
8.00	0.00	260.58	260.41	0.17
10.00	0.00	260.57	260.40	0.17
12.00	0.00	260.57	260.39	0.18
13.51	0.00	260.57	260.38	0.19

REVISION
A - PRELIMINARY ISSUE - FOR INFORMATION USE ONLY
MS MS MM 17/09/21
DES DWG CHK DATE



Tomkinson
SURVEY ENGINEERING PLANNING PROJECT MANAGEMENT
12/98-101 WESTERN AVENUE WESTWOODS PH 03 8746 9988
ASN T 103 583 58 WWW.TOMKINSON.COM



© COPYRIGHT
THE INFORMATION CONTAINED HEREIN IS THE PROPERTY OF TOMKINSON SURVEY ENGINEERING. ALL RIGHTS RESERVED. NO PART OF THIS DOCUMENT IS TO BE REPRODUCED OR TRANSMITTED IN ANY FORM OR BY ANY MEANS, ELECTRONIC OR MECHANICAL, INCLUDING PHOTOCOPYING, RECORDING, OR BY ANY INFORMATION STORAGE AND RETRIEVAL SYSTEM, WITHOUT THE WRITTEN PERMISSION OF TOMKINSON SURVEY ENGINEERING.

SCALE 1:250
LENGTHS IN METRES - PAPER SIZE A1



OOORANYA ESTATE - STAGE 16A
16 WHITESIDE STREET, BEVERIDGE
ROAD AND DRAINAGE PLAN
INTERSECTION DETAILS (SHEET 1 OF 2)
AUTHOR: MICHELLE COOKE
DATE: 17/09/2021
PROJECT ENGINEER:
PRELIMINARY S1488_16A-R&D06 A

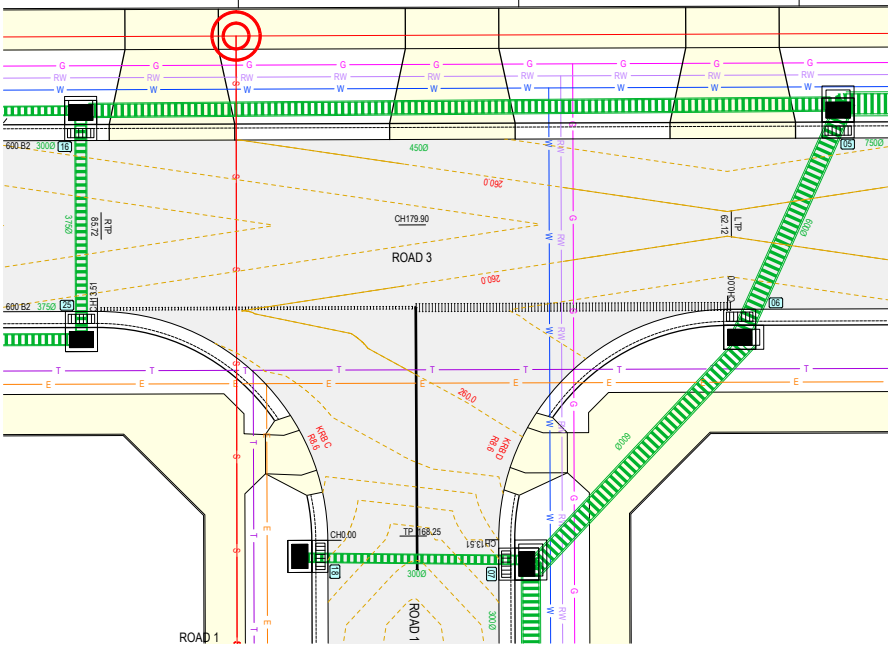

KRB-C
SCALE 1:500 V1:50

DESIGN LIP OF KERB	HORIZ. GEOMETRY	DATUM RL (2510)	EXISTING SURFACE	CHANGE
3.1%		260.13	260.47	0.00
1.6%		260.10	260.46	2.00
8.6% MC		260.08	260.46	3.10
0.9%		260.07	260.47	4.00
		260.06	260.48	6.00
		260.05	260.49	8.00
		260.04	260.51	10.00
		260.03	260.52	12.00
		260.03	260.54	13.51

KRB-D
SCALE 1:500 V1:50

DESIGN LIP OF KERB	HORIZ. GEOMETRY	DATUM RL (2510)	EXISTING SURFACE	CHANGE
0.9%		259.91	260.42	0.00
0.5%		259.92	260.42	2.00
6.75% MC		259.93	260.42	3.38
Rebbit MC		259.93	260.42	4.00
1.02%		259.95	260.42	6.00
16.75% MC		259.96	260.42	6.75
3.1%		259.98	260.43	8.00
		260.01	260.43	10.00
		260.06	260.44	10.13
		260.10	260.44	12.00
		260.10	260.44	13.51

REVISION
A PRELIMINARY ISSUE - FOR INFORMATION USE ONLY
MS MS 161 17/09/21
DES DWG CHK DATE



SCALE 1:100
LENGTHS IN METRES - PAPER SIZE A1
© COPYRIGHT
THE INFORMATION CONTAINED
HEREIN IS THE PROPERTY OF
OORANYA ENGINEERING AND
SHOULD NOT BE REPRODUCED
OR TRANSMITTED IN ANY
FORM OR BY ANY MEANS
WITHOUT PERMISSION IN
WRITING FROM OORANYA
ENGINEERING



OORANYA ESTATE - STAGE 16A
16 WHITESIDE STREET, BEVERIDGE
ROAD AND DRAINAGE PLAN
INTERSECTION DETAILS (SHEET 2 OF 2)
AUTHOR: T. MITCHELL, CONSULTANT
DATE: 17/09/2021
PROJECT ENGINEER:
PRELIMINARY S1458.16A-R&D07 A

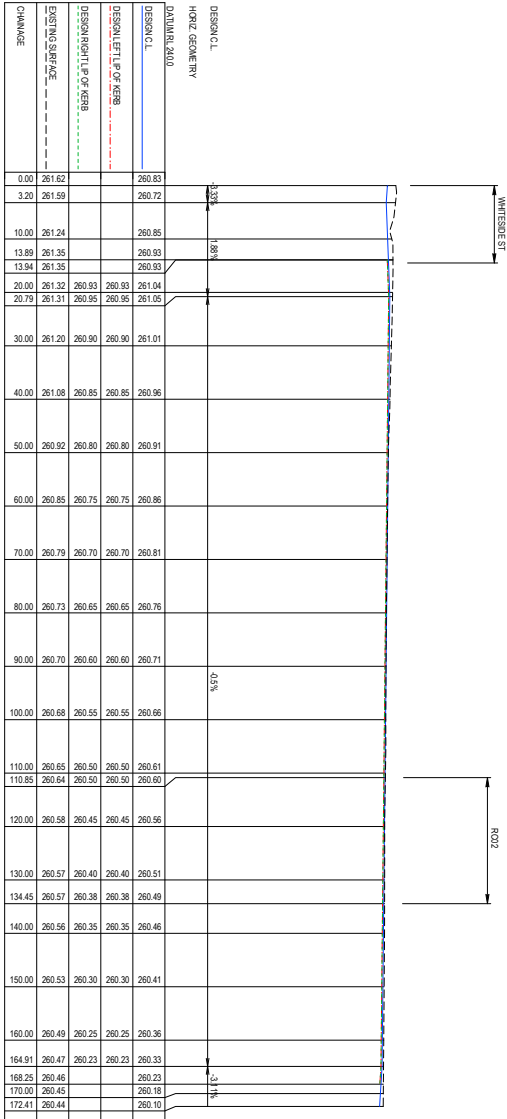

RC01 LONGITUDINAL SECTION

A PRELIMINARY ISSUE - FOR INFORMATION USE ONLY
 REVISION
 MS MS MM 17/09/21
 DES DWG CHK DATE



© COPYRIGHT
 THE INFORMATION CONTAINED
 HEREIN IS THE PROPERTY OF
 TOMKINSON ENGINEERING
 CONSULTANTS PTY LTD. ALL
 RIGHTS RESERVED. NO PART
 OF THIS DOCUMENT IS TO BE
 REPRODUCED OR TRANSMITTED
 IN ANY FORM OR BY ANY
 MEANS, ELECTRONIC OR
 MECHANICAL, INCLUDING
 PHOTOCOPYING, RECORDING,
 OR BY ANY INFORMATION
 STORAGE AND RETRIEVAL
 SYSTEMS, WITHOUT THE
 WRITTEN PERMISSION OF
 TOMKINSON ENGINEERING
 CONSULTANTS PTY LTD.

SCALE H: 1:200 V: 1:50
 H 0 5 10 15 20 25 H
 V 0.5 1 1.5 2 2.5 V
 LENGTH IN METRES 7 PAPER SIZE A4

OOORANYA ESTATE - STAGE 16A
 16 WHITESIDE STREET, BEVERIDGE
 ROAD AND DRAINAGE PLAN
 LONGITUDINAL SECTION (SHEET 1 OF 3)
 AUTHORITY: MITCHELL COUNCIL
 DRAWN BY: S1488
 DATE: 17/09/2021
 PROJECT: S1488_16A-R&D09 A

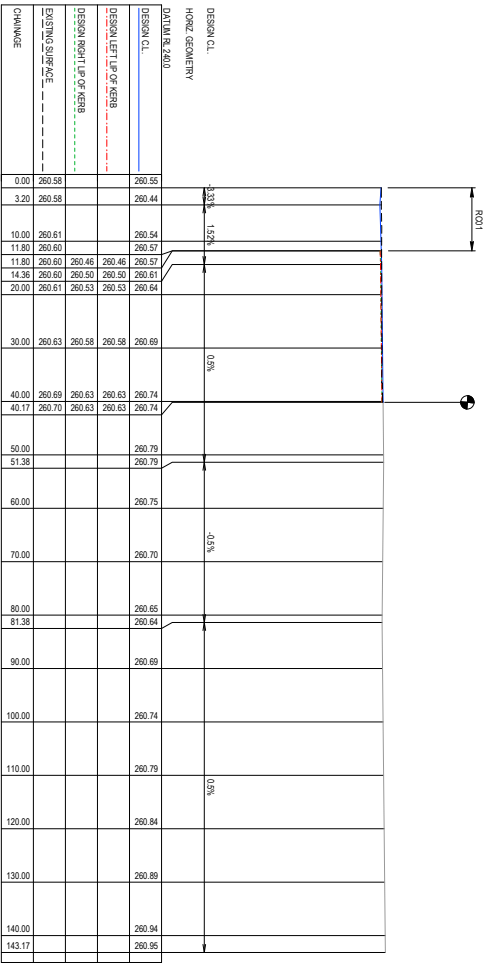

RC02 LONGITUDINAL SECTION

REV	DESCRIPTION	DATE
A	PRELIMINARY ISSUE - FOR INFORMATION USE ONLY	MS MS 141 17/09/21
	REVISION	DES DWG CHK DATE

Tomkinson
SURVEY ENGINEERING PLANNING PROJECT MANAGEMENT

12/99-101 WESTERN AVENUE WESTWILDOONS PH 03 8746 9988
ASN 11 10358558 WWW.TOMKINSON.COM

OORANYA
ENGINEERING

© COPYRIGHT
THE INFORMATION CONTAINED
HEREIN IS THE PROPERTY OF
OORANYA ENGINEERING
AND IS TO BE KEPT IN
CONFIDENTIALITY. ANY
REPRODUCTION OR
DISSEMINATION OF THIS
INFORMATION WITHOUT THE
WRITTEN PERMISSION OF
OORANYA ENGINEERING IS
STRICTLY PROHIBITED.

SCALE: H: 1:200 V: 1:50

0 5 10 15 20 25 M

0 0.5 1 1.5 2 2.5 V

DM YOU DIG
Don't Move You Dig

PROFESSIONAL ENGINEER
REGISTERED IN THE
STATE OF WESTERN AUSTRALIA

OORANYA ESTATE - STAGE 16A
16 WHITESIDE STREET, BEVERIDGE
ROAD AND DRAINAGE PLAN
LONGITUDINAL SECTION (SHEET 2 OF 3)

AUTHOR: T. MITCHELL
DRAWN: M. MITCHELL
CHECKED: M. MITCHELL
DATE: 17/09/2021
PROJECT NUMBER: S1488_16A-R&D10A

PRELIMINARY

REVISION
 MS MS 141 17/09/21
 DES DWG CHK DATE
 A PRELIMINARY ISSUE - FOR INFORMATION USE ONLY



SCALE 1:200 V 1:50
 0 5 10 15 20 25 M
 0 5 10 15 20 25 M
 0 5 10 15 20 25 M

© COPYRIGHT
 THE INFORMATION CONTAINED
 HEREIN IS THE PROPERTY OF
 TOMKINSON ENGINEERING
 CONSULTANTS PTY LTD
 ALL RIGHTS RESERVED
 NO PART OF THIS DOCUMENT
 MAY BE REPRODUCED OR
 TRANSMITTED IN ANY FORM
 OR BY ANY MEANS
 WITHOUT THE WRITTEN
 PERMISSION OF TOMKINSON
 ENGINEERING CONSULTANTS
 PTY LTD

16 WHITESIDE STREET, BEVERIDGE
 ROAD 01 CROSS SECTIONS
 AUTHORITY: WEST COAST
 PROJECT: S1488 16A-R&D12A
 PRELIMINARY

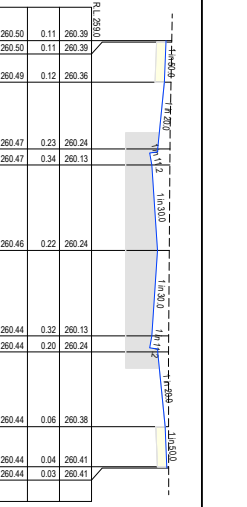
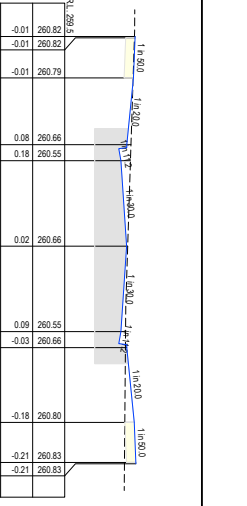
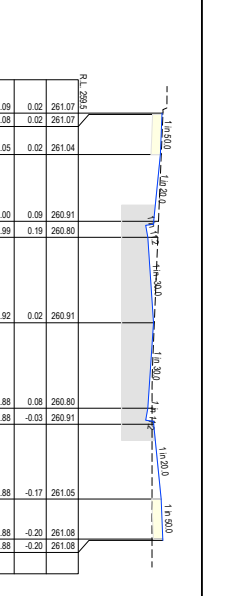
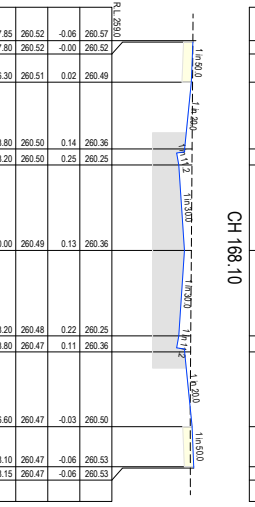
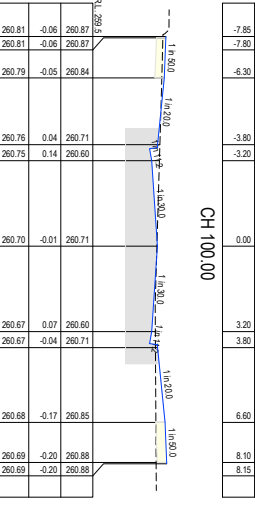
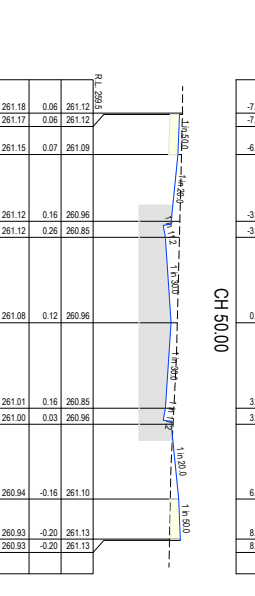
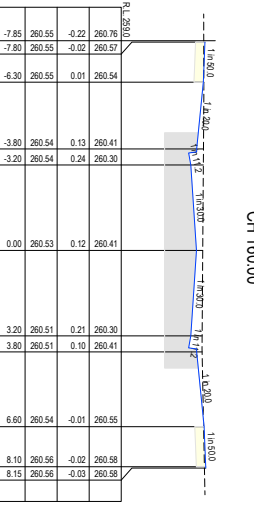
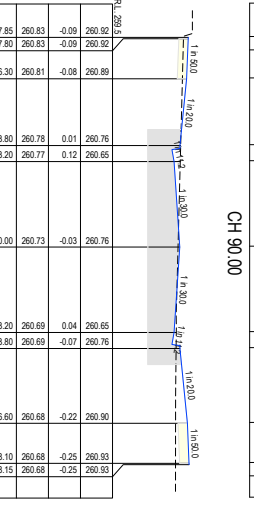
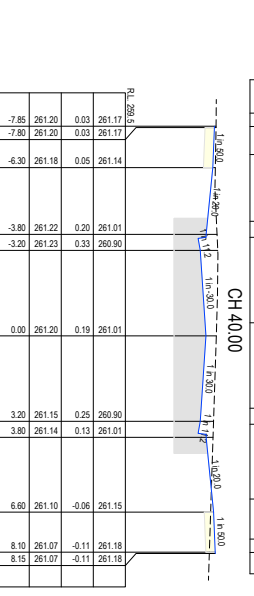
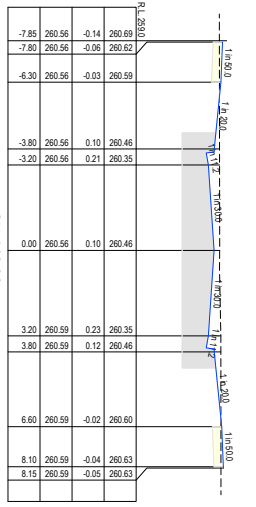
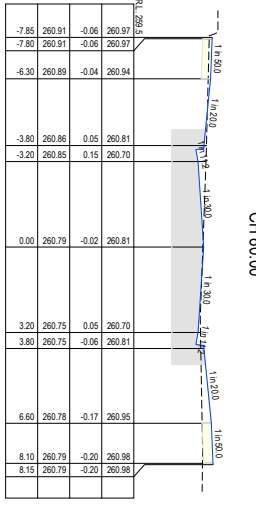
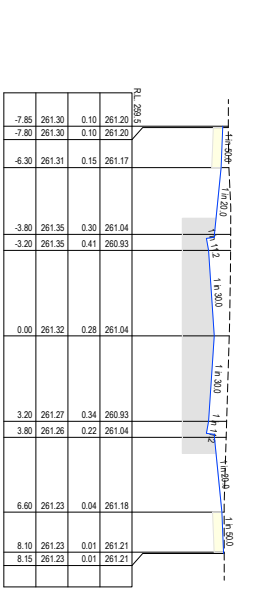
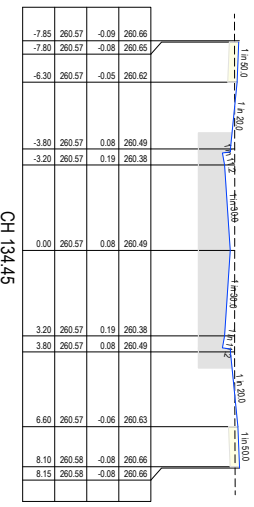
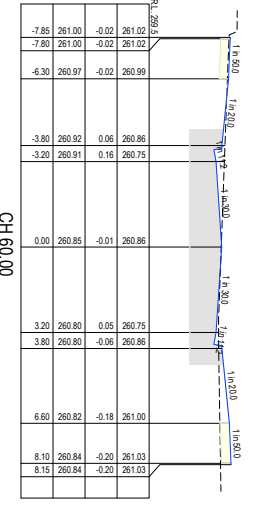
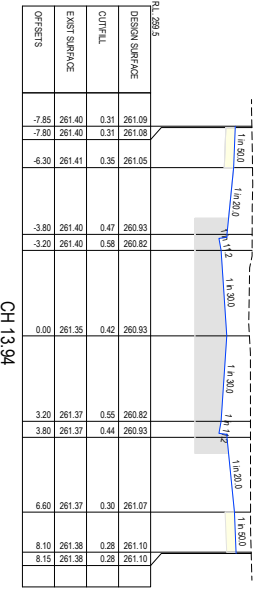

A PRELIMINARY ISSUE - FOR INFORMATION USE ONLY
 REVISION MS MS 16A 17/09/21
 DES DWG CHK DATE



SCALE H:1:200 V:1:50
 0 5 10 15 20 25 H
 0 5 10 15 20 25 V
 0 0.5 1 1.5 2 2.5 M
 LENGTHS IN METRES *PAPER SIZE A
 © COPYRIGHT
 THE INFORMATION CONTAINED
 HEREIN IS THE PROPERTY OF
 TCG CONSTRUCTIONS PTY LTD
 AND IS NOT TO BE REPRODUCED
 OR TRANSMITTED IN ANY FORM
 OR BY ANY MEANS, ELECTRONIC
 OR MECHANICAL, INCLUDING
 PHOTOCOPYING, RECORDING,
 OR BY ANY INFORMATION
 STORAGE AND RETRIEVAL
 SYSTEMS, WITHOUT PERMISSION
 IN WRITING FROM TCG
 CONSTRUCTIONS PTY LTD

OOORANYA ESTATE - STAGE 16A
 16 WHITESIDE STREET, BEVERIDGE
 ROAD AND DRAINAGE PLAN
 ROAD 02 CROSS SECTIONS
 AUTHORITY: MITCHELL COUNCIL
 PROJECT NO: 16A-R&D13A
 PROJECT ENGINEER
PRELIMINARY S1488.16A-R&D13A

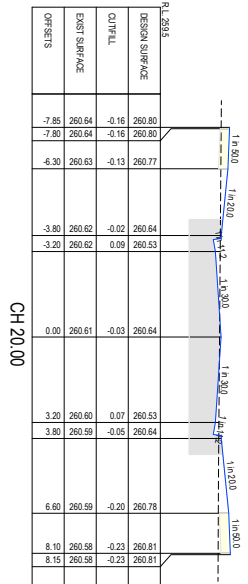
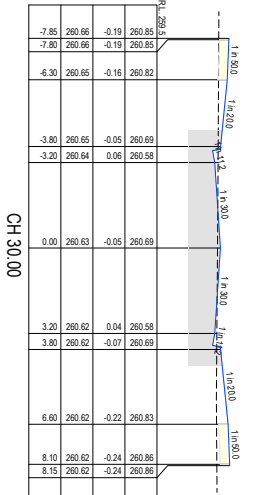
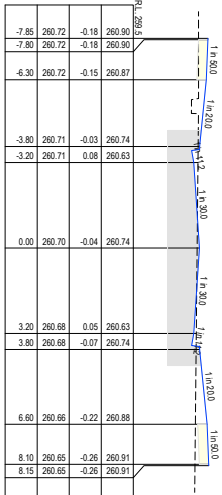



© COPYRIGHT
 THE INFORMATION CONTAINED
 HEREIN IS THE PROPERTY OF
 TOMKINSON ENGINEERING
 CONSULTANTS AND SHALL REMAIN
 THE PROPERTY OF TOMKINSON
 ENGINEERING CONSULTANTS
 THROUGHOUT THE PROJECT
 PERIOD.

SCALE: H: 1:200 V: 1:50
 0 5 10 15 20 25 H
 0 0.5 1 1.5 2 2.5 V
 LENGTHS IN METRES - 1:20 SCALE H
 LENGTHS IN METRES - 1:50 SCALE V

OOORANYA ESTATE - STAGE 16A
16 WHITESIDE STREET, BEVERIDGE
ROAD AND DRAINAGE PLAN
ROAD 03 CROSS SECTIONS
 AUTHORITY: MICHELLE COULDA
 CONSULTANTS: ROAD DEVELOPMENTS PT
PRELIMINARY S1458.16A-R&D14A

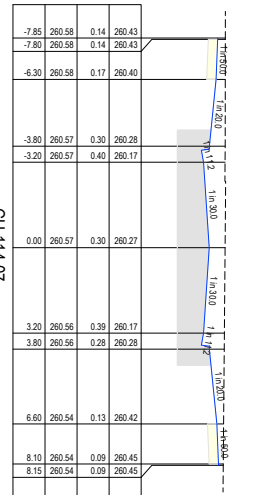
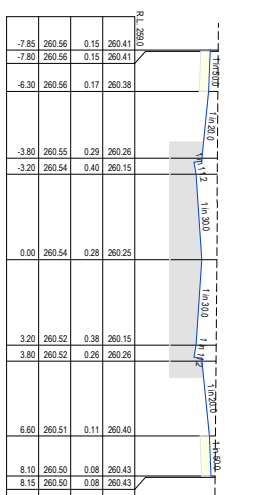
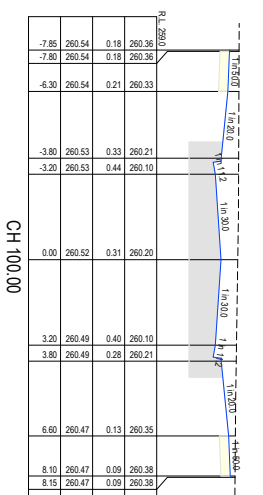
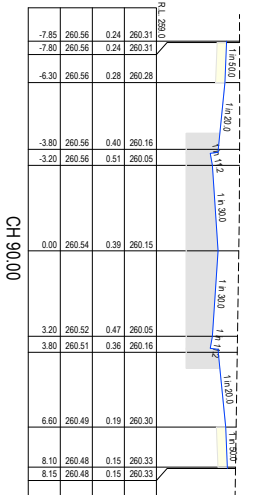
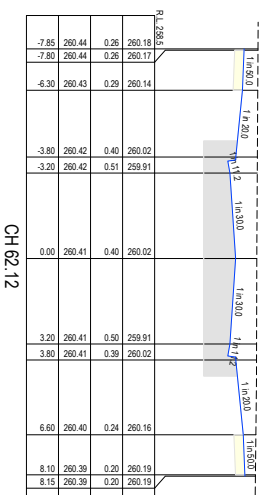
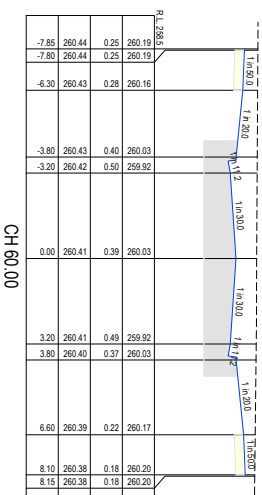
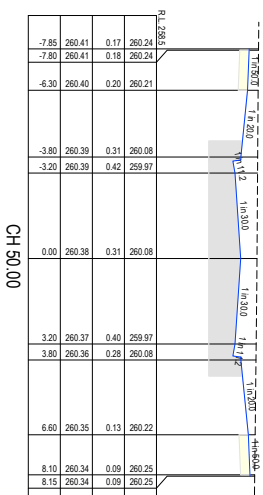
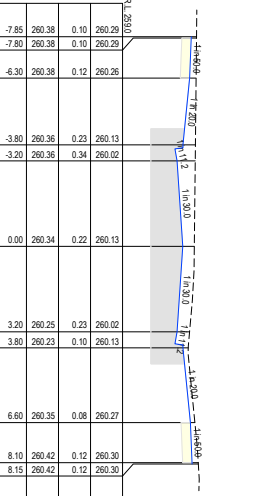
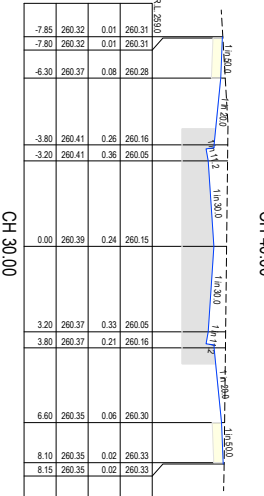
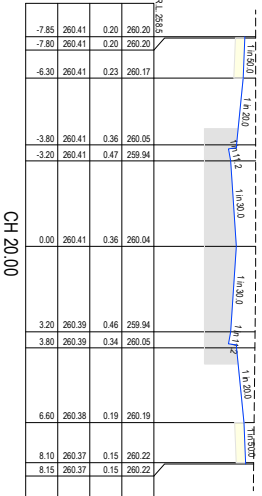
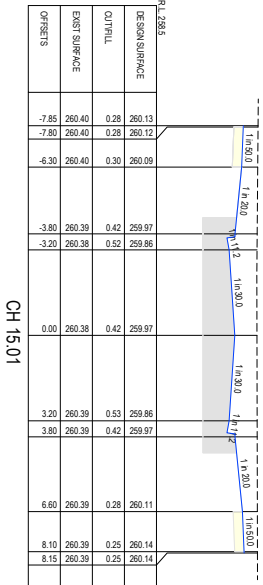

PIT NO	PIT TYPE	SETOUT (PIT CENTRE)		DIMENSIONS			INLET			OUTLET			PIT	REMARKS
		EASTING	NORTHING	WIDTH	LENGTH	DA	DA INV.LEV	DA	DA INV.LEV	LD LEVEL	DEPTH			
1	EP	320122.005	5850035.155	750	1200	750	257.734	750	257.738	260.277	2.562	AS PER EDCM S0 023.607		
2	JP	320130.292	5850036.368	1200	1200	750	257.815	750	257.815	260.349	2.535	AS PER EDCM S0 023.607		
3	GSEF	320117.367	5850051.029	1200	1200	750	257.815	750	257.815	260.349	2.535	AS PER EDCM S0 023.605		
4	GSEF	320130.009	5850048.737	1050	900	750	257.921	750	257.921	260.176	2.255	AS PER EDCM S0 023.605		
5	GSEF	320159.429	5850048.503	1050	900	750	257.921	750	257.921	260.073	2.043	AS PER EDCM S0 023.607		
6	GSEF	320163.522	5850054.789	900	1200	600	258.079	600	258.079	260.044	1.965	AS PER EDCM S0 023.609		
7	GSEF	320172.780	5850060.182	900	1200	600	258.138	600	258.138	260.292	2.154	AS PER EDCM S0 023.610		
8	GSEF	320176.272	5850094.122	900	1050	300	258.296	600	258.296	260.516	2.220	AS PER EDCM S0 023.612		
9	GSEF	320183.731	5850104.947	600	900	300	258.296	300	259.129	260.845	1.716	AS PER EDCM S0 023.614		
10	GSEF	320183.738	5850224.043	600	900	300	259.142	300	259.142	260.017	1.716	AS PER EDCM S0 023.615		
11	GSEF	320183.738	5850224.043	600	900	300	259.142	300	259.142	260.419	1.840	AS PER EDCM S0 023.616		
15	JP	320186.689	5850027.738	600	900	225	258.024	260.419	258.024	260.419	2.394	AS PER EDCM S0 023.617		
16	GSEF	320187.643	5850043.569	750	900	300	258.227	450	258.227	260.166	1.939	AS PER EDCM S0 023.618		
17	GSEF	320214.094	5850046.752	600	900	300	258.747	260.295	258.747	260.295	1.548	AS PER EDCM S0 023.620		
18	GSEF	320184.160	5850064.081	600	900	300	258.843	260.280	258.843	260.280	2.037	AS PER EDCM S0 023.621		
19	GSEF	320184.871	5850093.181	600	900	300	258.992	260.509	258.992	260.509	2.117	AS PER EDCM S0 023.622		
20	GSEF	320193.884	5850101.628	750	900	450	258.558	260.659	258.558	260.659	2.051	AS PER EDCM S0 023.623		
21	GSEF	320194.816	5850109.152	600	900	300	258.664	300	258.664	260.095	1.942	AS PER EDCM S0 023.625		
22	GSEF	320192.583	5850117.983	600	900	300	258.850	300	258.850	260.633	1.783	AS PER EDCM S0 023.626		
23	GSEF	320192.381	5850160.023	600	900	300	259.285	300	259.285	260.845	1.560	AS PER EDCM S0 023.628		
24	GSEF	320197.988	5850273.119	600	900	300	259.799	260.963	259.799	260.963	1.164	AS PER EDCM S0 023.628		
25	GSEF	320188.375	5850052.093	600	900	375	258.333	375	258.333	260.162	1.829	AS PER EDCM S0 023.629		
26	GSEF	320215.015	5850049.202	600	900	375	258.733	260.295	258.733	260.295	1.562	AS PER EDCM S0 023.630		
27	GSEF	320203.537	5850093.807	600	900	450	258.073	260.759	258.073	260.759	1.786	AS PER EDCM S0 023.631		

- NOTES:
- ALL PITS ARE TO EDCM STANDARDS UNLESS NOTED OTHERWISE.
 - STUBS AND PIPE ENDS TO BE BLOCK WITH MARINE GRADE PLYWOOD TO AUTHORITY SATISFACTION.
 - ALL GRATES TO BE BIRLE SAFE GRATES.
 - PIT SETOUT TO CENTRE OF PIT UNLESS NOTED OTHERWISE.
 - WW= SWING WALL, JP= JUNCTION PIT, GSEF= GRATED SIDE ENTRY PIT, DGSEF= DOUBLE GRATED SIDE ENTRY PIT, GP= GRADED PIT.

A PRELIMINARY ISSUE - FOR INFORMATION USE ONLY

REVISION

MS MS MM 17/09/21

DES DWG CHK DATE



SCALE 1:80

0 5 10 15 20 25

LENGTHS IN METRES - 1/8"= 1" PER SIZE A1

DO NOT YOU DIG

© COPYRIGHT
THE INFORMATION CONTAINED HEREIN IS THE PROPERTY OF TOMKINSON SURVEY ENGINEERING PLANNING PROJECT MANAGEMENT. IT IS TO BE USED ONLY FOR THE PROJECT AND SITE SPECIFICALLY IDENTIFIED IN THIS DOCUMENT. ANY REUSE OR REPRODUCTION OF THIS INFORMATION WITHOUT THE WRITTEN PERMISSION OF TOMKINSON SURVEY ENGINEERING IS STRICTLY PROHIBITED.

OOORANYA ESTATE - STAGE 16A
16 WHITESIDE STREET, BEVERIDGE
ROAD AND DRAINAGE PLAN
PIT SCHEDULE
AUTHORITY: MITCHELL COUNCIL
PROJECT STATUS: CONCEPTS/ROAD DEVELOPMENTS PH
PROJECT NUMBER: S1488.16A-R&D16A
REV: PRELIMINARY

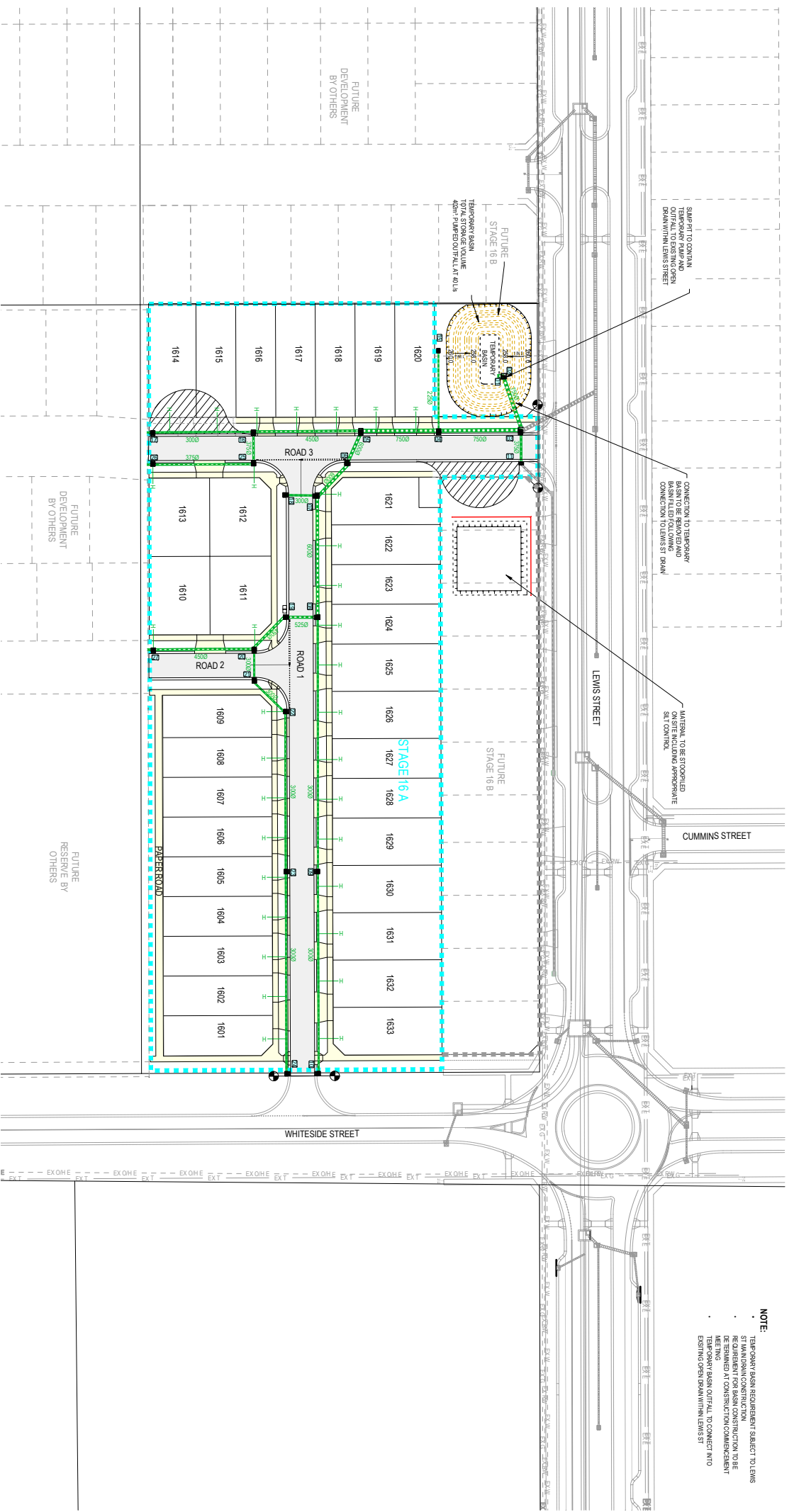

NOTE:

- TEMPORARY BASIN REQUIREMENT SUBJECT TO LEWIS STREET MODIFICATION CONSTRUCTION REQUIREMENTS FOR BASIN CONSTRUCTION TO BE DETERMINED AT CONSTRUCTION COMMENCEMENT MEETING
- TEMPORARY BASIN OUTFALL TO CONNECT INTO EXISTING OPEN DRAIN WITHIN LEWIS STREET

A PRELIMINARY ISSUE - FOR INFORMATION USE ONLY
 REVISION: _____ MS MS MM 17/09/21 DES DWG CHK DATE

Tomkinson
 SURVEY ENGINEERING PLANNING PROJECT MANAGEMENT
 12/99-101 WESTERN AVENUE WESTWOODS PH 03 8746 9988
 ASN 11 10338358 WWW.TOMKINSON.COM

OORANYA
 CONSULTANTS

© COPYRIGHT THE NATIONAL ENGINEERING CONSULTANTS ASSOCIATION OF AUSTRALIA (NECA) ALL RIGHTS RESERVED. THIS DOCUMENT IS THE PROPERTY OF TOMKINSON CONSULTANTS. IT IS TO BE USED ONLY FOR THE PROJECT AND SITE SPECIFICALLY IDENTIFIED IN THE TITLE. IT IS NOT TO BE REPRODUCED OR TRANSMITTED IN ANY FORM OR BY ANY MEANS, ELECTRONIC OR MECHANICAL, INCLUDING PHOTOCOPYING, RECORDING, OR BY ANY INFORMATION STORAGE AND RETRIEVAL SYSTEM, WITHOUT THE WRITTEN PERMISSION OF TOMKINSON CONSULTANTS.

SCALE 1:500
 LENGTHS IN METRES DIMENSIONS IN METRES 1/8" = 1"

DMU YOU DIG
 THE NATIONAL ENGINEERING CONSULTANTS ASSOCIATION OF AUSTRALIA (NECA)

PROFESSIONAL ENGINEER

16 WHITESIDE STREET, BEVERIDGE
ROAD AND DRAINAGE PLAN
TEMPORARY BASIN DETAIL PLAN
 AUTHORITY: MICHELLE COOK
 DATE: 17/09/2021
 PROJECT: S1488_16A-R&D17A

PRELIMINARY S1488_16A-R&D17A